

Support Bulletin

Penmap Project Manager create template from existing

GEOSPATIAL, January 2021

The following bulletin describes how to create a new template from an existing one.

Requires Penmap Project Manager equal or higher version 10.8.6.1456. Penmap Project Manager is available via Trimble Installation Manager.

Create a new template based on an existing one

To create a new template

1. select your **Trimble Connect Project** in Penmap Project Manager
2. go to **Settings**.

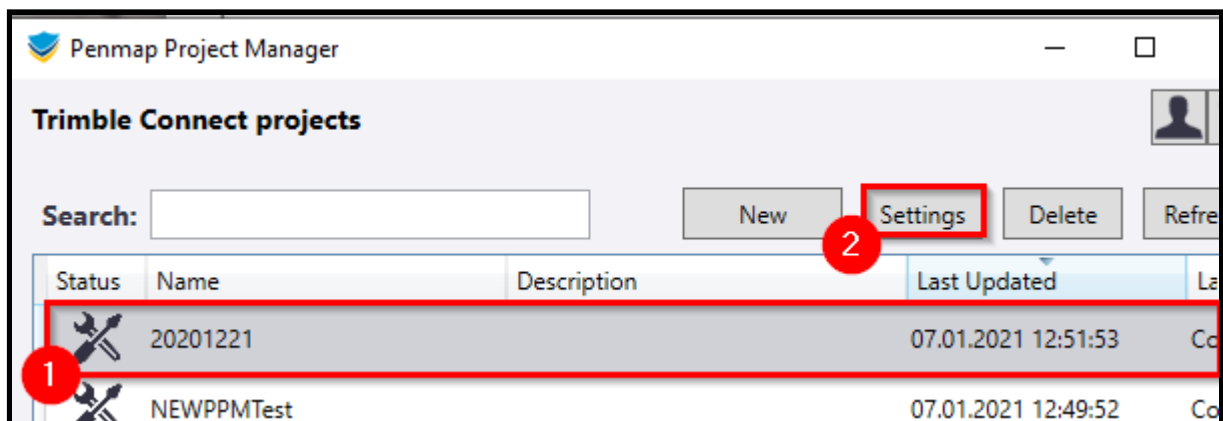

3. Select **Penmap Templates**
4. **Create**

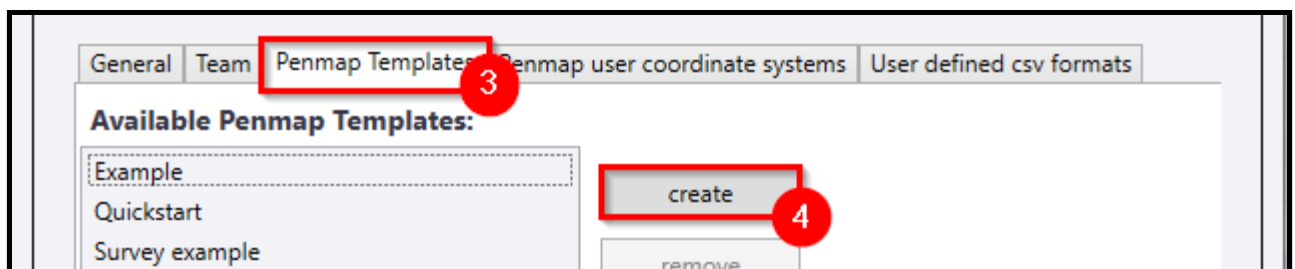

5. **Set the name** for the new template
6. **Select the existing template** which should be duplicated
7. **Create**

<https://geospatial.trimble.com>

www.trimble.com

New Template

Please enter the name for the template:

Name:
 5

Duplicated from:
 6

7

8. The iFeature Editor opens and it's possible to adjust your template as needed
9. save it with **OK**

iFeature Editor

Feature	Page	GIS status
Road r	Topo	None
Road l	Topo	None
Talus up	Topo	None
Talus down	Topo	None
Fence	Topo	OK
Shore	Topo	OK
Manhole	Topo	OK
Wall	Topo	OK
Curb	Topo	OK
Building	Topo	OK
Street light	Topo	OK
Gully	Topo	OK

8 adjust template

9 save

10. The template is available now to create new projects from

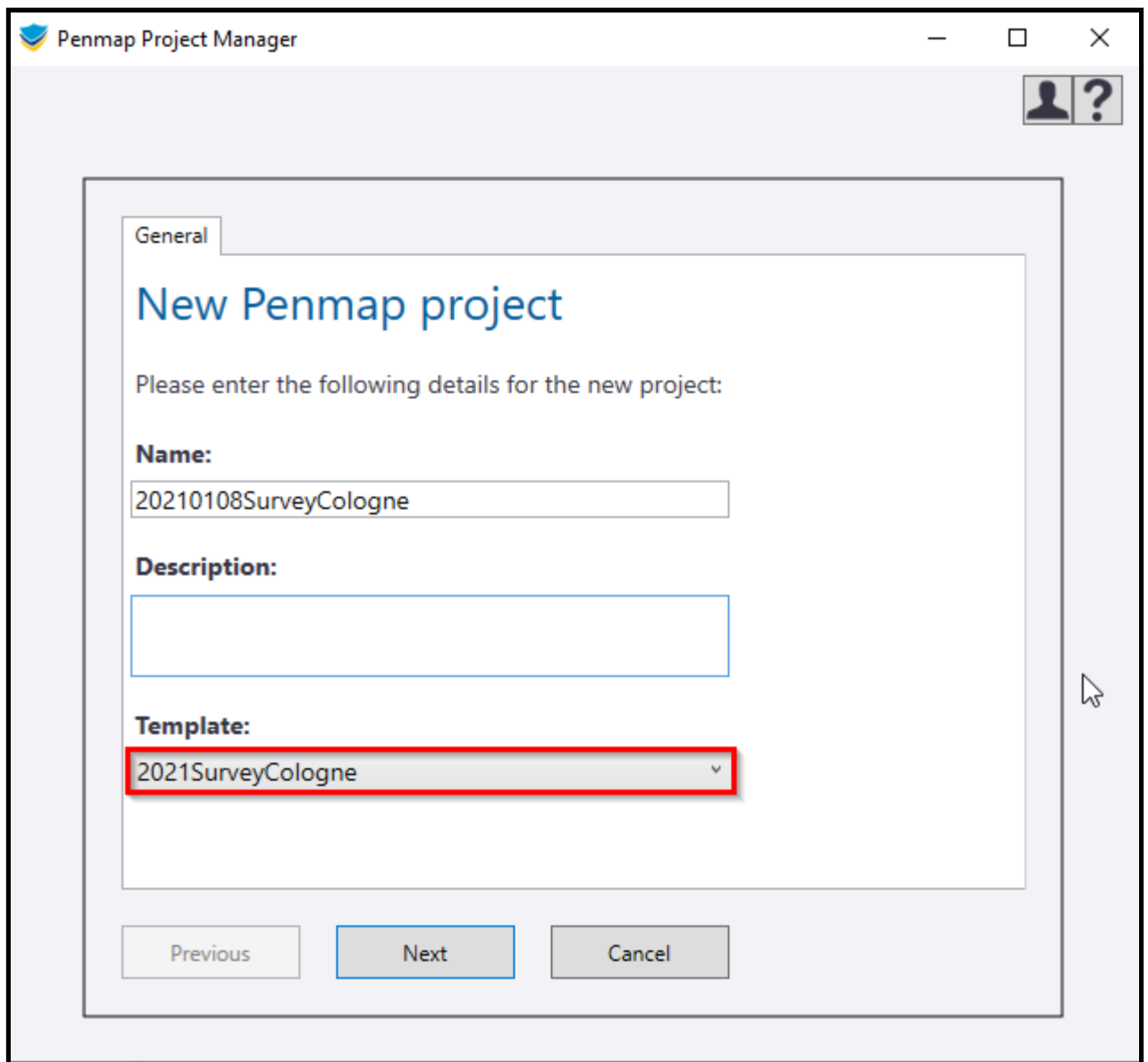
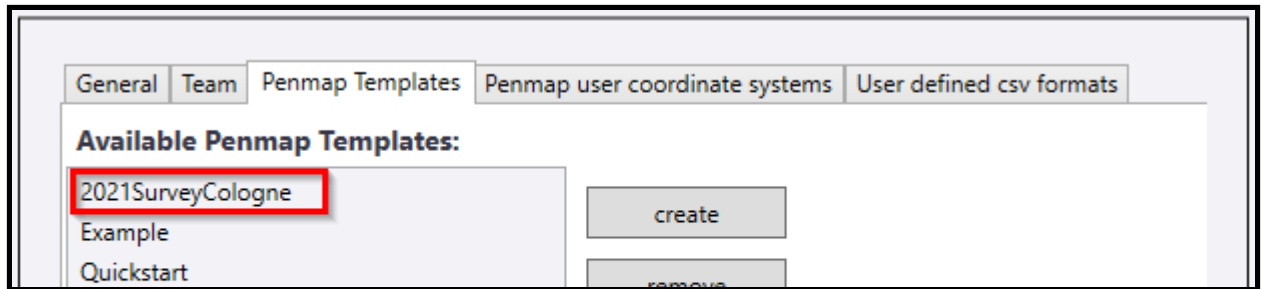

Contact

For more information or questions contact the Trimble Penmap community.

<https://community.trimble.com/groups/penmap-for-andriod>

<https://geospatial.trimble.com>

www.trimble.com